

PROVIDING THE DIFFERENCES



## COMPANY PROFILE

### EMES

PROVIDES THE DIFFERENCES IN

MEP DESIGN

INTEGRATED M&E

MEP CONTRACTING

CONTRACT MAINTENANCE

# OVERVIEW



# OUR STORY

## OVERCOMING CHALLENGES

Emes had faced many challenges due to the impact of the COVID-19 pandemic, but with the efforts and commitment of our leaders, the company has achieved significant achievement and stable growing up.

## 2030 VISION

**ESTABLISHMENT**  
Company was founded under name Emes.

2015

2020

2022

**ACCELERATING**  
Emes applies advanced management platforms for all activities from project management to office operation. Key success of these platforms will help us to server the best services to our customer with our vision for sustainable developments.

## OUR COMMITMENT



**0% FATAL**  
during implementation



**SATISFACTION**  
at handover



**ON TIME DELIVERY**  
following project baseline



*We are not just successful engineering contractors, but we set our goals higher in ensuring sustainability for the environment and contributing to social responsibility. In addition to the quality, safety, and timely delivery indicators, we always pursue superior values to create a difference and sustainable development.*

**Pham Dinh Ha | CEO**



## UNCOMPROMISED HEALTH & SAFETY

At Emes, we make no compromises on health and safety, and have adopted a zero injury policy.

As a strategy of our HSE system we will focus on the safety in the day one based on the preventive risk plan.



## QUALITY MANAGEMENT SYSTEM

Our quality policy is easy to understand, it is tried to reach of Zero Defects Programme. Emes have a track record of high profile quality installations of key members in the past.

## BUSINESS VALUES

### 1 MISSION

We are committed to providing value driven engineering services. Our team works with every client, from large companies to small municipalities, to determine their goals for their own infrastructure. We are committed to designing and building projects that maximize the value our clients receive from their investment. We devote our talents and resources to completing projects on schedule and within our clients' budgetary constraints

### 2 VISION

EMES's vision is to become a MEP contractor to provide the difference in the field of designing and constructing mechanical and electrical systems, meeting all the requirements and desires of customers. We strive continuously to create effective, sustainable, and safe technical solutions, while contributing to the sustainable development of society and the environment.

### 3 CORE VALUE



#### PEOPLE CENTREDNESS

Always placing employees at the center, employees are the most valuable assets of the company.



#### CUSTOMER CENTRIC

Always listen and understand customers' requirements to provide the most suitable solutions.



#### QUALITY

The quality of service provided to customers is the lifeblood of the company.



#### SAFETY

Working safely is the foundation for a happy life with loved ones and family.



#### INNOVATION

To learn and continuously improve technical solutions to provide cost-effective and efficient solutions.



#### COLLABORATION

Collaboration and sharing are essential to provide customers with the best products.

# BUSINESS



## BUSINESS SERVICES

Our experience counts, it's evident in the way we anticipate your needs, look ahead for options, identify potential pitfalls and add engineering value through effective integrated M&E plans.

We always be proactive approach ensures that projects are always better organized, better run, of better quality and are consistently delivered on time and on budget.

That's the Emes difference.

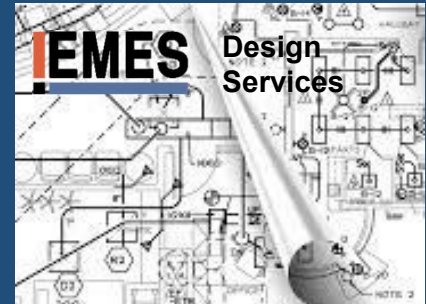



Emes is the integrated M&E contractor of choice to any client & partner professionals tasked to deliver on high profile and demanding installations and maintenance projects.

## EXPERIENCE ACROSS DIVERSE SECTORS

Our public sector work includes parliament buildings, court houses, new build hospitality and the refurbishment of healthcare facilities, Office plus significant Residential.

In the private sector our solutions focused approach has brought us worked in factory, retail, residential and commercial projects.

Emes make commercial sense, meeting deadlines and delivering value on all projects where quality and bottom line performance go hand in hand.

Please visit our website for more information  
[www.emes.com.vn](http://www.emes.com.vn)



# BUSINESS SECTORS

RESIDENTIAL



RETAIL



OFFICE

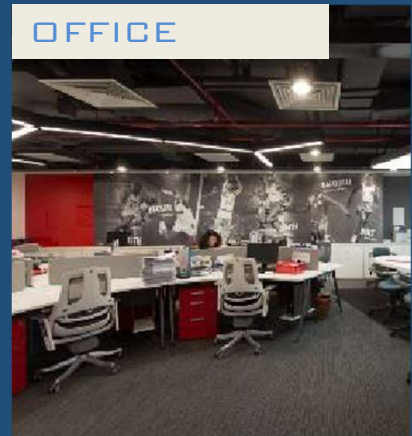

EDUCATION

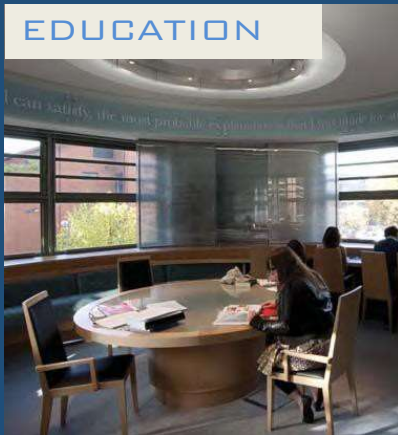

COMMERCIAL



FACTORY

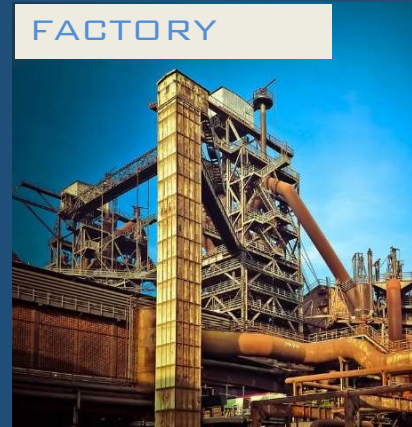

HEALTH CARE

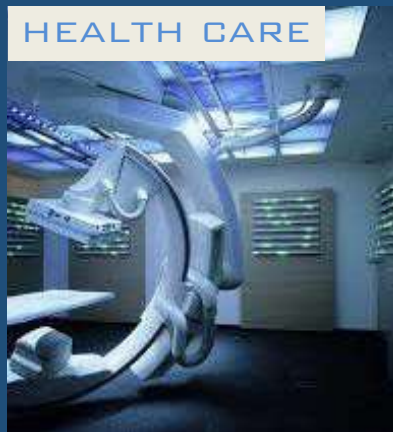

F&B



HOSPITALITY



## MEP DESIGN CONSULTANCY

### POWERFUL DESIGN FOR EFFICIENT PROJECTS

From your project's very first concept, our sophisticated design process ensures the journey to completion is swift and smooth.

The combination of our highly experienced engineering team with the very latest technology provides a streamlined design service. This puts you in control and enables installations to take place without hassle or inconvenience.

From blueprints to independents, countless companies entrust their electrical, mechanical and specialist design needs to the Emes. Our design process is distinguished by a number of factors:



The latest software packages providing you with formal design calculations and print-out records in the format you require.

Purpose-designed in-house facilities featuring 2D and 3D AutoCAD and up to A0 color printing. This offers you complete flexibility when visualizing and reviewing your plans. Upon project completion you receive electronic 'as fitted' manuals, ensuring clear and comprehensive reference material for your company's future.



Clients with multiple sites can receive Design and Test Certification on some special software. This allows you to maintain a database of your buildings' electrical installations and the associated test results.

## MEP DESIGN CONSULTANCY

### PRECISION PRICING

We attach great importance to the work of our estimating engineers. They are equipped with the most sophisticated software to ensure our prices are not only accurate for the job but represent the very best value for money.

Emes stands for quality, and we are confident you will not find a company providing the same level of work at more competitive rates. We also ensure you can budget accurately by providing swift and comprehensively calculated costs, including fixed prices.



Good methodologies for cost estimation

Good solutions for saving cost



Providing excellence through innovative design and accurate cost estimation

## MEP CONTRACTING

EMES is all about delivering M&E excellence.

Designing and installing the essential mechanical and electrical services that make buildings a great environment in which to work, learn, heal or play.

### INTEGRATED M&E

## INSTALLATION EXCELLENCE

M&E Infrastructure

HVAC and Plumbing

Power Installations

Lighting

Building Management

Systems

Monitoring and Alert

Systems

Data & Communication

Security System

Our full service offers completely integrated M&E project management, starting with design, leading to specification, supply and closely managed installation on site.

Where projects have challenging timeframes or restricted access, EMES will respond with innovative manpower solutions and options such as off site fabrication.

Well structured testing and commissioning programs are an essential part of our pre-handover service. On completion, the quality of our initial design work leads to an efficient maintenance contract.



## **INTEGRATED M&E**

OUR SERVICE IS 'SOLUTIONS FOCUSED', ADDING ENGINEERING VALUE AND ENSURING THE OPTIMUM OUTCOME IN EACH PROJECT.



The key people in EMES has extensive experience of working within “live” education, health and retail environments.

Our effective planning and innovative thinking has minimized disruption to our clients' facilities despite major works associated with data, power and ventilation systems





The value of integrated M&E is driven by Emes's ability to incorporate all trades within a specific project team from an early stage in the process. This well developed discipline allows for seamless co-ordination of information exchange, technical submissions, approval of samples and the efficient procurement of bespoke plant and equipment.

With such strong processes in place and over 10 years of experience worked for corporate projects of our key members, it is little wonder that we often outperform our clients' deadlines and are able to plan, execute and manage volumes of work on projects which competitors find too challenging to accept.



WE MAKE 'COMMERCIAL SENSE' DELIVERING VALUE ON ALL PROJECTS WHERE QUALITY AND BOTTOM LINE PERFORMANCE GO HAND IN HAND.



At Emes the need to deliver value is not a compromise on quality but rather an intelligent approach to how the use of time and choice of materials can be optimized through planning, collaboration and experience.

Value lies beyond the installed cost so we invest in technology and know how to deliver better life-cycle costs. Our Integrated M&E service looks ahead to minimize future running costs and simplify maintenance issues. We welcome opportunities to come on board at an early stage when the maximum benefit from our expertise can be shared.





## **M & E MAINTENANCE**

Every project needs a strategy and resource to ensure the smooth operation of essential services.

Emes M&E maintenance provides an excellent means of keeping projects safe and alive.

### CONTRACT MAINTENANCE

## MAINTENING EXCELLENCE



With 24 hour cover available 7 days a week and for 52 weeks each year, EMES is always ready to deliver an efficient and effective maintenance service matched to specific requirements.

Some situations demand full time support from one of our embedded engineers who will be on hand to deal with any urgent needs that could arise and would hinder the operation of a building or endanger its users.



Many existing clients can utilize our mobile engineer service, giving rapid response but without the cost of full time cover. With our extensive M&E team linked by tracker and mobile technology, we can offer response times as low as one hour.

FOR US, 'RELIABLE' MEANS DELIVERING MAINTENANCE CONSISTENTLY ON-TIME AND ON-BUDGET.



Our help desk and after hour helpline rapidly direct our engineers to a wide range of private and public sector facilities. Each engineer is fully equipped and backed up by round the clock availability of materials and spares.

Hotline: 0 9 8 5 6 4 5 5 8 7



# CAPABILITIES



## OUR CAPABILITIES



# OUR CAPABILITIES

ỦY BAN NHÂN DÂN  
THÀNH PHỐ HỒ CHÍ MINH  
SỞ XÂY DỰNG

CỘNG HÒA XÃ HỘI CHỦ NGHĨA VIỆT NAM  
Độc lập - Tự do - Hạnh phúc

**CHỨNG CHỈ**  
**NĂNG LỰC HOẠT ĐỘNG XÂY DỰNG**

Số: HCM-00067146

*(Ban hành kèm theo Quyết định số 1721/QĐ-SXD-QLNGDXD ngày 19/9/2022)*

Tên tổ chức: CÔNG TY TNHH KỸ THUẬT DỊCH VỤ CƠ ĐIỆN EMES  
Giấy chứng nhận đăng ký doanh nghiệp/Quyết định thành lập số: 0313111741  
Ngày cấp: Đăng ký cấp lần đầu ngày 26/01/2015, thay đổi lần thứ 5 ngày 19/8/2022;  
Nơi cấp: Sở Kế hoạch và Đầu tư Thành phố Hồ Chí Minh;  
Tên người đại diện theo pháp luật:  
Ông/Bà: **Phạm Đình Hà** Chức vụ: Giám đốc  
Địa chỉ trụ sở chính: Số 212/96 Thoại Ngọc Hầu, phường Phú Thạnh, quận Tân Phú,  
Thành phố Hồ Chí Minh  
Số điện thoại: 0908262157 Số fax:  
Email: info@emes.com.vn Website: www.emes.com.vn

Phạm vi hoạt động xây dựng:

1. Thiết kế, thẩm tra thiết kế xây dựng công trình dân dụng, nhà công nghiệp: Hạng III;
2. Thi công công tác xây dựng công trình dân dụng, nhà công nghiệp, công nghiệp năng lượng, hạ tầng kỹ thuật: Hạng III;
3. Thi công lắp đặt thiết bị vào công trình dân dụng, nhà công nghiệp: Hạng III;
4. Tư vấn giám sát lắp đặt thiết bị vào công trình dân dụng, nhà công nghiệp: Hạng III.

Chứng chỉ này có giá trị đến hết ngày: 19/9/2032.J.

Thành phố Hồ Chí Minh, ngày 19 tháng 9 năm 2022

KT. GIÁM ĐỐC  
PHÓ GIÁM ĐỐC



Huỳnh Thanh Khiết

## OUR LEADERSHIPS



**PHAM DINH HA**

*Co-Founder, Managing Director*

Having years of intensively practical experiences with solid background in M&E services, Ha leads his team to plan and direct numerous projects in all areas of Vietnam, and he is adept at managing multiple projects simultaneously. He also monitor, track, prepare documentation for our project and pull together all facets of MEP construction process on time and within budget has resulted in client satisfaction and repeat business.

**BUI PHAN DUY VIET**

*Founder, Project Director*

Having 17 years working experience for several reputable developers and consultants, overseeing projects across various sectors including industrial (factories, shipyards), infrastructure (airports), commercial (offices and retail fit-outs), hospitality, F&B from new build to renovation project. Viet's experience spans across different job functions such as planning & design, tendering/bidding management, cost estimation, construction progress, quality control and contract negotiation and management, and especially well knowing authority submission processes.



# PERFORMANCE



# BUSINESS REPORT

## ANNUAL REVENUE

Increasing business growth up has been made in the last 5 years, with key operating and financial factors improved significantly although the Covid pandemic affected to all businesses. We have reached the target with the commitment of our mission & vision to clients and partners.

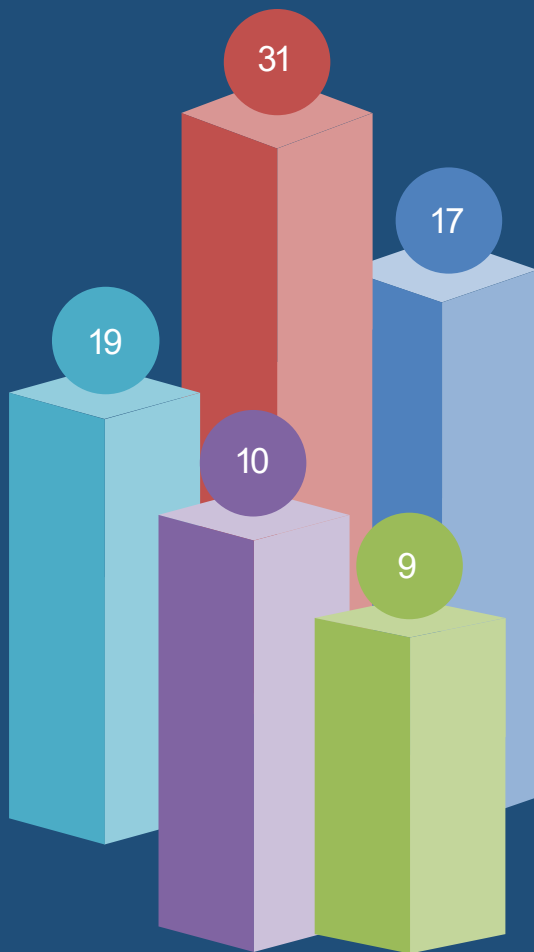
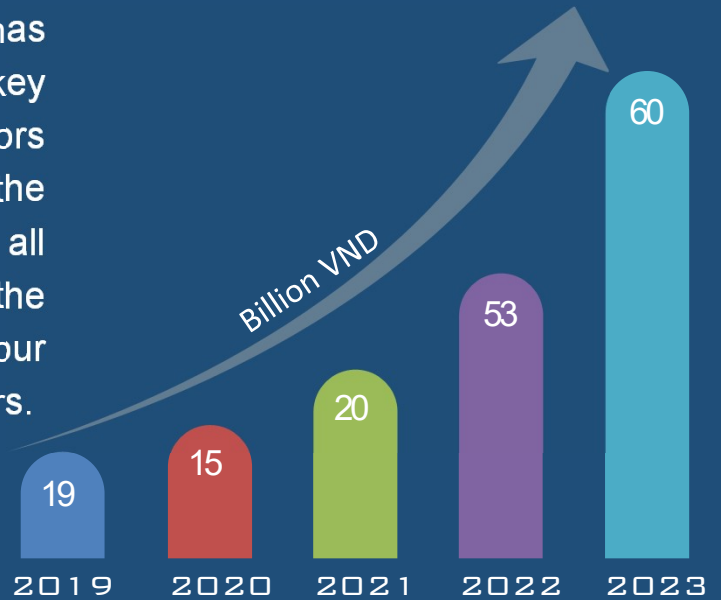

## CONTRACT SIGNED

The number of contract signed over the last 5 years has steadily increased of the revenues. We are transforming the business from the commercial projects to industrial projects helping us gained the higher income within less than project signed.



# MAJOR CLIENTS

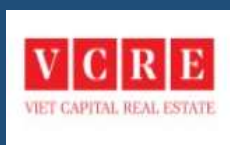

## MAJOR PARTNERS



# REFERENCES



## INDUSTRIAL PROJECTS



SAMTEC FACTORY VIETNAM  
LONG THANH IC, DONG NAI, VIETNAM

CLIENT: SAMTEC VIETNAM  
SCALE: 12,500 SQM  
CONSTRUCTION PERIOD: 6 MONTHS  
SCOPE OF WORK: FULL MEP PACKAGE  
SECTOR: ELECTRONIC FACTORY

### PROJECT DESCRIPTION

Samtec is a company specializing in the manufacturing and supply of high-performance electronic and optical connectivity solutions for electronic devices, computers, telecommunications, and medical equipment.

Although project is delaying over 4 months due to Fire protection approval from landlord but Emes has the contingency plan to coordinate with main contractor, and Project management to delivery the best result to client.

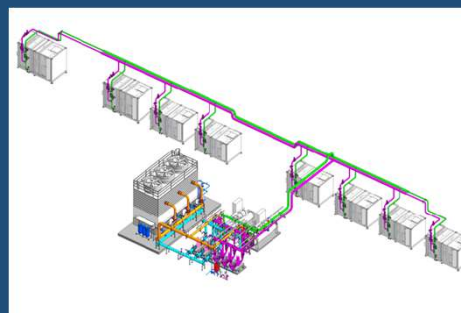

## INDUSTRIAL PROJECTS



KANSAI PAINT VIETNAM  
THUAN AN, BINH DUONG, VIETNAM

CLIENT:	KANSAI-ALPHANAM
SCALE:	2,800 SQM
CONSTRUCTION PERIOD:	2 MONTHS
SCOPE OF WORK:	FULL MEP PACKAGE
SECTOR:	PRODUCT WAREHOUSE



### PROJECT DESCRIPTION

Kansai Paint is one of the leading companies in the world in the field of manufacturing and trading of paint. The company specializes in producing high-quality paints that meet various customer needs in different areas such as automotive paint, industrial paint, architectural paint, decorative paint, and food packaging paint.

Kansai Paint assigned Emes contractor to design and construct a dynamic electrical system and lighting system for their warehouse. Emes provided an intelligent design solution based on their experience with storage, production, research, and development areas, optimizing costs and increasing production efficiency. Specifically, Emes proposed an energy-efficient lighting solution with extended lifespan, reducing environmental impact and long-term operational costs.

Additionally, Emes selected appropriate production operation times to maximize productivity and minimize maintenance time. They also coordinated between systems and improved construction issues within the warehouse to complete the project and hand it over before the deadline, meeting the needs and requirements of Kansai Paint.

▶ OFFICE PROJECTS



IBM VIETNAM  
CAPITAL PLACE, HA NOI, VIETNAM

However, Emes faced strict demands from the client, requiring the project to be completed within 2 months, despite some special equipment needing to be imported within 4 months. To ensure the project was completed on time, Emes proposed the best options including renting equipment for temporary use and transporting new equipment by air to ensure the IT room operated well and reduce the time of goods transportation. All of Emes' efforts helped IBM complete the project quickly and effectively, bringing satisfaction to the client.

- CLIENT: IBM VIETNAM-HANOI
- SCALE: 700 SQM
- CONSTRUCTION PERIOD: 2 MONTHS
- SCOPE OF WORK: MEP DESIGN & BUILD
- SECTOR: OFFICE

**PROJECT DESCRIPTION**

IBM is a manufacturer and seller of computer hardware, software, infrastructure, server services, and consulting in many fields from mainframes to nanotechnology.

Emes came up with ideas and collaborated with 3D Interior Design to create a design that meets IBM's requirements and complies with green standards, ensuring human health and energy efficiency. During the construction process, Emes also used a high safety target construction process and coordinated project departments to speed up and deliver the project on time to get IBM's office up and running quickly and effectively.

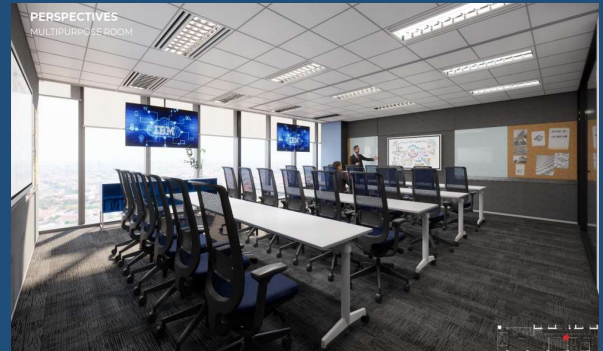

▶ OFFICE PROJECTS



INTEL VIETNAM – SS3  
THU DUC CITY, HO CHI MINH

Besides, to meet the owner's requirements for shortening the construction time by 20 days from the original plan, Emes actively responded by increasing resources and accelerating the delivery of materials using air transportation at their own expense.

Despite the slow equipment import process due to the impact of the COVID-19 pandemic, Emes completed the project ahead of schedule and all systems were properly operated. This demonstrates Emes' sense of responsibility, professionalism, and focus on ensuring product quality, meeting customer needs, and achieving good results in a difficult business environment.

CLIENT: INTEL VIETNAM  
SCALE: 6,000 SQM  
CONSTRUCTION PERIOD: 3.5 MONTHS  
SCOPE OF WORK: FULL MEP BUILD SERVICES  
SECTOR: OFFICE

**PROJECT DESCRIPTION**

Intel Vietnam as the Project Sponsor/ The Client intends to renovate, expand, and fit out an office space at Level 3, SS3 building of nearly 6000m2 sq. m located Lot I2, Road D1, Saigon Hi-Tech Park, Tan Phu Ward, 9 District, Ho Chi Minh City, Vietnam as part of their business expansion plan.

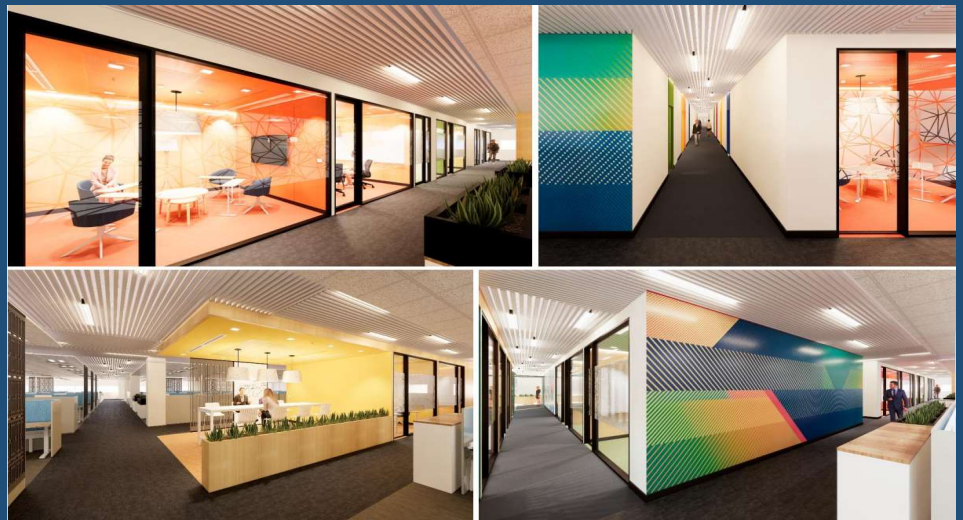

Emes was selected as MEPF main contractor to provide full MEPF build service for their office renovation. In this project, Emes was taken the MEPF construction works that complied with green standards and utilized an intelligent BMS control system.

The big constrain is the short schedule within 90 days for a whole construction work.

## FOOD & BEVERAGE PROJECTS



### MCDONALD'S VIETNAM

- HA NOI
- HAI PHONG
- NHA TRANG
- HO CHI MINH
- BINH DUONG

CLIENT: *GOOD DAY*

SCALE: *600 SPM (CHAINS)*

CONSTRUCTION PERIOD: *1.5 MONTHS/STORE*

SCOPE OF WORK: *FULL MEP DESIGN & BUILD SERVICES*

SECTOR: *FOOD & BEVERAGE*

### PROJECT DESCRIPTION



McDonald's Vietnam is a fastfood restaurant franchise chain that meets international standards with a high-quality management system.

Emes was tasked with designing and implementing the entire mechanical and fire safety system for this project, ensuring the highest safety and quality standards.

With 24/7 operation, Emes prioritized design and construction to ensure progress and future maintenance of the system.

With experience in constructing projects in shopping centers, Emes is capable of working continuously day and night to ensure safety, health, and progress. The contractor arranged 3 teams to work in 3 shifts to meet the opening requirements according to the schedule of the store and the investor.



## ▶ FOOD & BEVERAGE PROJECTS



ECLIPSE BAR &  
RESTAURANT

HAGL BUILDING, YANGON CITY,  
MYANMAR

CLIENT: *DRAGON INDUSTRIES ASIA*

SCALE: *550 SQM*

CONSTRUCTION PERIOD: *2 MONTHS*

SCOPE OF WORK: *FULL MEP DESIGN &  
BUILD SERVICES*

SECTOR: *FOOD & BEVERAGE*



### PROJECT DESCRIPTION

ECLIPSE BAR & RESTAURANT is a bar and restaurant located in a bustling area of the city. Designed with modern and luxurious interior with dim lighting, it creates a cozy and intimate atmosphere.

This was a challenging project for Emes as they were tasked with designing and constructing the mechanical, electrical, and plumbing systems for a project outside of Vietnam's territory. They had to rely on both in-house and local manpower, as well as shipping goods and equipment from Vietnam, which involved dealing with customs procedures and transportation. However, Emes demonstrated their determination and capability in delivering the project on time. This reflects the professionalism and expertise of Emes in implementing international projects.

▶ **HOSPITALITY PROJECTS**



OAKWOOD HOTEL

UNG VAN KHIEM, HO CHI MINH, VIETNAM

CLIENT: *OAKWOOD RESIDENTIAL & HOSPITALITY*

SCALE: *2,000SQM*

CONSTRUCTION PERIOD: *3 MONTHS*

SCOPE OF WORK: *FULL MEP DESIGN & BUILD SERVICES*

SECTOR: *HOSPITALITY*

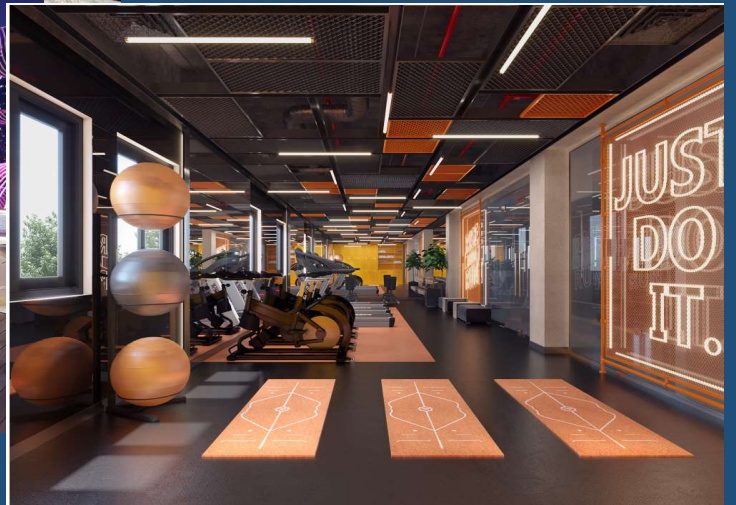

**PROJECT DESCRIPTION**

Oakwood Hotel is a luxurious and modern hotel located in the city center. With its convenient location, the hotel provides guests with an excellent staying experience with many high-end amenities. The hotel offers a variety of beautiful and modern rooms with amenities such as air conditioning, flat-screen TV, refrigerator, safe, and private bathroom with full facilities. In addition, the hotel also has a restaurant and bar serving a wide range of food and drinks.

The task assigned for this tender package is to design and construct the MEP system and renovate the fire-fighting system in areas ranging from the ground floor, 1st floor, corridors on floors 1 to 11, kitchen and gym entertainment area within 3 months. With such a tight schedule, Emes had to prepare carefully and comply with safety regulations and tight progress schedule in close cooperation with the contractor. We specialize in interior design, construction and basic construction to quickly and effectively complete the handover area.

## RESIDENTIAL PROJECTS



THE MANOR CENTER PARK  
HA NOI, VIETNAM

CLIENT: *BITEXCO*  
SCALE: *4,750 SQM/19 VILLAS*  
CONSTRUCTION PERIOD: *11 MONTHS*  
SCOPE OF WORK: *FULL MEP & BUILD SERVICES*  
SECTOR: RESIDENTIAL



### PROJECT DESCRIPTION

The Manor Central Park Hanoi is designed with a system of high-end apartment buildings, villas, townhouses, and entertainment areas.

In this project, the contractor was tasked with constructing the MEP system for 19 adjacent apartments, each comprising 5 floors with a floor area ranging from 60-75m<sup>2</sup>. The challenge for Emes during this stage was the widespread outbreak of Covid-19 and the closure of many places. However, the contractor implemented the government's '3 on the spot' measures, prepared additional manpower, and negotiated with suppliers to ensure the project was completed on schedule.

For more information please contact us  
as the address below or visit us now at:

[www.emes.com.vn](http://www.emes.com.vn)



**Office:**

212/96 Thoai Ngoc Hau Street, Phu Thanh Ward, Tan Phu District, Ho  
Chi Minh City, Viet Nam

Tel: +84-028 6293 3330 Email: [info@emes.com.vn](mailto:info@emes.com.vn)

Web: [www.emes.com.vn](http://www.emes.com.vn)

Hotline: 0985 645 587